

INDUSTRIAL BAY WITH
DOCK LOADING
// ± 6,400 SF

FOR LEASE

7519 30 Street SE, Bay E, Calgary, AB



Erik Dobrovolsky | Senior Associate, Industrial Sales & Leasing
403.613.7161 | edobrovolsky@cdnglobal.com

CDN Global Advisors Ltd. 736 6th Ave SW, Suite 1010
Calgary, Alberta T2P 3T7 www.cdnglobal.com

CDNGLOBAL[®]
Commercial Real Estate Advisors

PROPERTY HIGHLIGHTS



PROPERTY DETAILS:

- Excellent central Foothills location
- Building under new ownership/management
- LED lighting to be installed throughout office and warehouse
- Marshalling for 53' trailers
- Scramble parking
- Immediate access to 30th Street SE, Glenmore Trail and Barlow Trail SE

PROPERTY OVERVIEW

Address:	7519 - 30 Street SE, Bay E
District:	Foothills Industrial
Zoning:	I-G (Industrial General)
Total Square Footage:	± 6,400 SF - TBD SF
Clear Height:	24' (TBV)
Loading:	1 Front Dock (12' x 12')
Lease Rate:	\$13.00 PSF
Op. Costs (Est. 2023):	\$3.69 PSF
Availability:	90 days from unconditional offer.



PROPERTY PICTURES // 7519 – 30 Street SE, Bay E

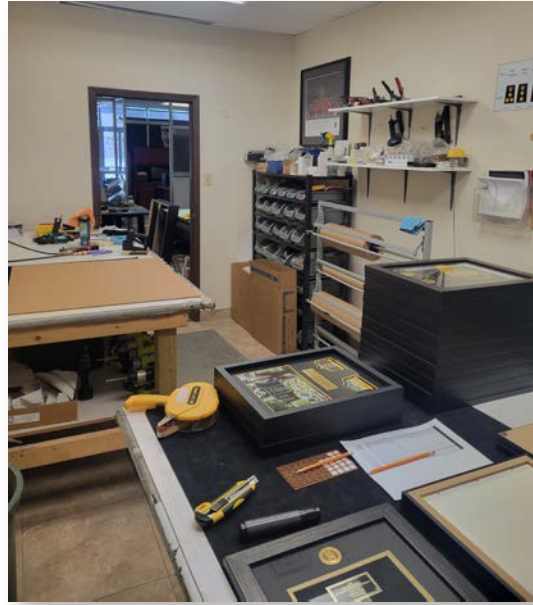
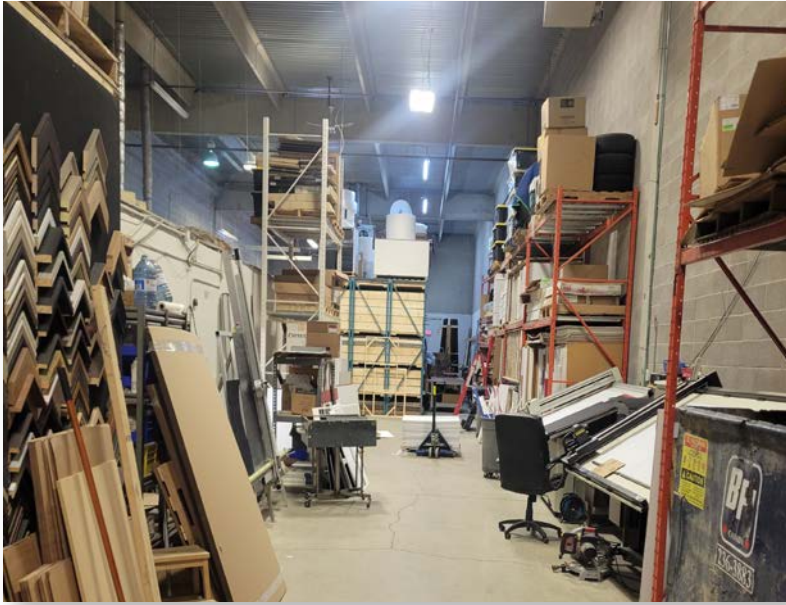

LOCATION

Located in Southeast Calgary, Foothills industrial district, with convenient access to major thoroughfares such as Glenmore Trail SE, Barlow Trail SE, and Deerfoot Trail SE

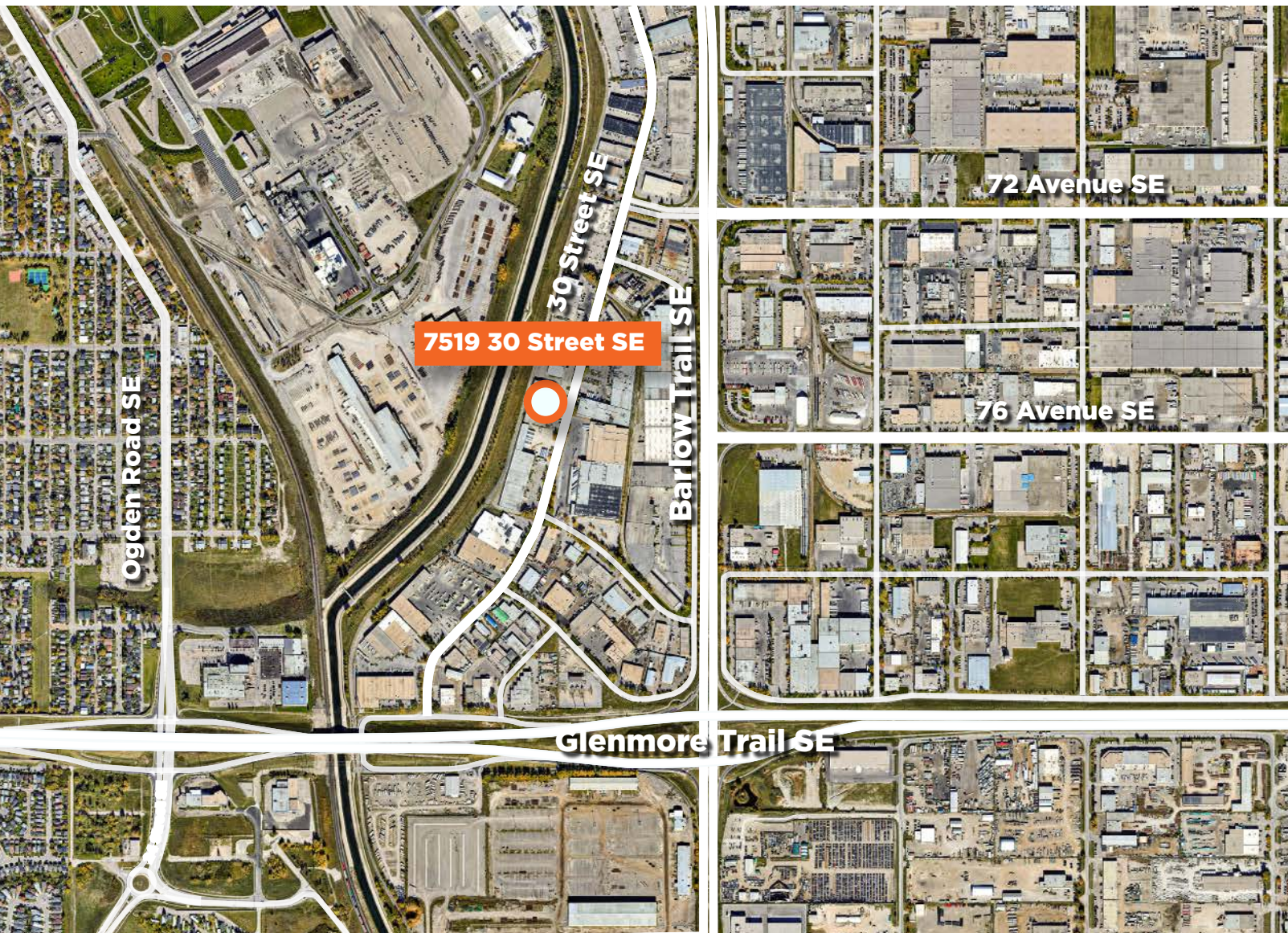

Drive Times:

Glenmore Trail SE: **2 minutes**

Deerfoot Trail SE: **7 minutes**

Stoney Trail SE: **8 minutes**

Downtown Calgary **12 minutes**

Calgary Airport: **20 minutes**

Nearby Amenities

Easy accessibility & close proximity to:



Close proximity to
Glenmore Trail and
Deerfoot Trail NE



Bus Routes on 30
Street SE and Barlow
Trail SE



Located in the Heart of
Foothills Industrial

FLOOR PLAN

Warehouse (main floor)

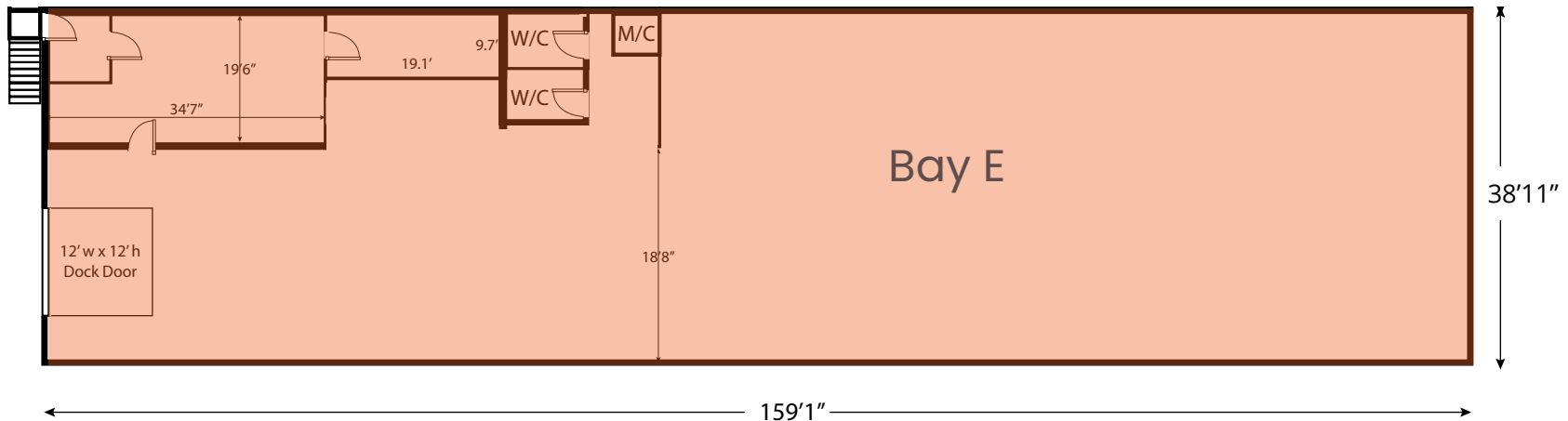

Floor plan not to scale; measurements are only approximated; only to be used for illustration purposes

Erik Dobrovolsky | Senior Associate, Industrial Sales & Leasing
403.613.7161 | edobrovolsky@cdnglobal.com

This communication is intended for general information only and not to be relied upon in any way. Consequently, no responsibility or liability whatsoever can be accepted by CDNGLOBAL for any loss or damage resulting from any use of, reliance on or reference to the contents of this document, including hypertext links to external sources. In addition, as a general communication, this material does not necessarily represent the view of CDNGLOBAL in relation to particular properties or projects. This communication is not intended to cause or induce breach of any agency agreement. Reproduction or distribution of this communication in whole or in part is not allowed without prior written approval of CDNGLOBAL.